



MEETINGS AND EVENTS

# WELCOME

THE HOTEL'S UNDERSTATED, BOUTIQUE STYLE IS EPITOMISED BY LIGHT, AIRY PUBLIC SPACES, MODERN ARTWORK AND CHIC FURNISHINGS.

Each of the rooms has its own unique character with elegant bathrooms and stunning suites.

The popular Steak & Lobster restaurant, serving mouth-watering steak and fresh lobster, is a relaxed and comfortable setting for dinner or a fruity cocktail.



Free high-speed Wi-Fi up to 150mbps on an unlimited number of devices



Edward, our virtual concierge is available to guests and meeting organisers 24/7





# FOOD FOR THOUGHT

DISCOVER WORLD-CLASS DINING IN AN ICONIC LOCATION

Our food and drink teams are here to ensure you stay energised, motivated and focused, with a range of delicious menus to choose from. We promise to go above and beyond to bring you the very best in innovative and responsible gastronomy.

Specifically designed to improve efficiency and your ability to concentrate, we have a fantastic range of simple, wholesome and tasty offerings. Menus can be tailored to your tastes, and our expert teams - dedicated and discreet, can set the scene to match the mood.

# EDWARD FOR MEETINGS







MEET EDWARD:  
YOUR DEDICATED  
CONFERENCE HOST

Edward is an innovative and unique chatbot, developed specifically to match the needs of the hospitality industry. He responds to guests' requests via SMS text messaging. Edward is available to all residential guests and organisers at the hotel.



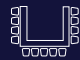

# CAPACITIES

|            |  |  |  |  |  |  |  |
|------------|---|---|---|---|---|--|---|
|            | Theatre   | Classroom   | Boardroom   | U-shape   | Cabaret   | Reception  | Lunch/Dinner  |
| Red Room   | —   | —   | 4   | —   | —   | —  | 4   |
| Green Room | —   | —   | 10  | —   | —   | —  | 10  |

# FLOOR DIMENSIONS

|                | Area               | Length m (ft) | Width m (ft) | Height m (ft) |
|----------------|--------------------|---------------|--------------|---------------|
| Private Room 1 | 75 m2 (807 ft2)    | 21 m (226')   | 6.7 m (72')  | 2.6 m (28')   |
| Private Room 2 | 96.6 m2 (1039 ft2) | 14 m (151')   | 6.9 m (74')  | 2.4 m (26')   |





# GROUND FLOOR

ALL MEETING ROOMS ARE FULLY AIR  
CONDITIONED AND BENEFIT FROM:

- Free, fast Wi-Fi up to 150Mbps
- Dedicated audio-visual support
- LCD projection screens
- Business centre with printing facilities

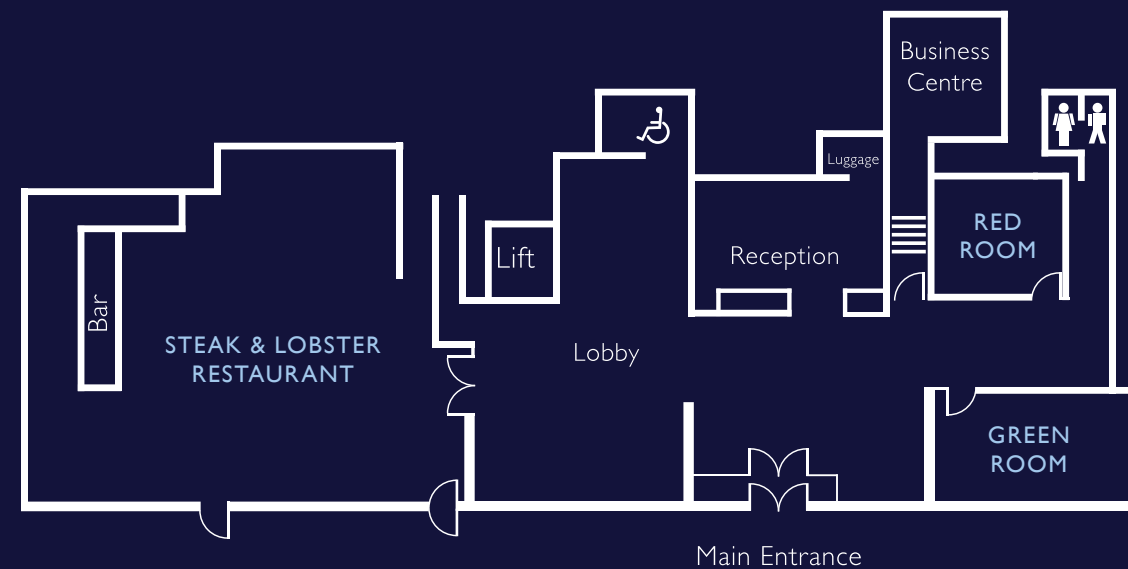

# LOCATION

DISCOVER AN UNDERSTATED,  
BOUTIQUE-STYLE HOTEL IN  
LONDON'S MARBLE ARCH

Moments away from Hyde Park  
and Selfridges sits the Sussex hotel,  
with modern artwork, characterful  
bedrooms and a popular restaurant,  
just minutes from Marble Arch  
tube station.

## SUSSEX ★★★★★

19-25 Granville Place  
London  
W1H 6PA

**T** +44 (0)20 7845 8680  
**E** [sussexcb@radisson.com](mailto:sussexcb@radisson.com)

## TRAVEL

### Car Park

Bryanston Street  
(charges apply)

### Underground

Marble Arch (Central Line)

Bond Street

(Jubilee and Central Lines)

### Crossrail

Bond Street (Elizabeth Line)

### Trains

Marylebone (0.8 mile)

Victoria (2 miles)

King's Cross St. Pancras

Eurostar (2.5 miles)

### Airport

City Airport (6 miles)

Heathrow (18 miles)

Gatwick (28 miles)

Luton (35 miles)

Stansted (37 miles)

## POINTS OF INTEREST

- 1 Selfridges (2 mins walk)
- 2 Marble Arch (5 mins walk)
- 3 Hyde Park (6 mins walk)
- 4 Bond Street (8 mins walk)
- 5 Park Lane (8 mins walk)
- 6 Oxford Street (9 mins walk)
- 7 Baker Street (10 mins walk)
- 8 Mayfair (10 mins walk)
- 9 Edgware Road (15 mins walk)
- 10 Regent Street (15 mins walk)
- 11 Oxford Circus (15 mins walk)
- 12 Madame Tussauds London (17 mins walk)

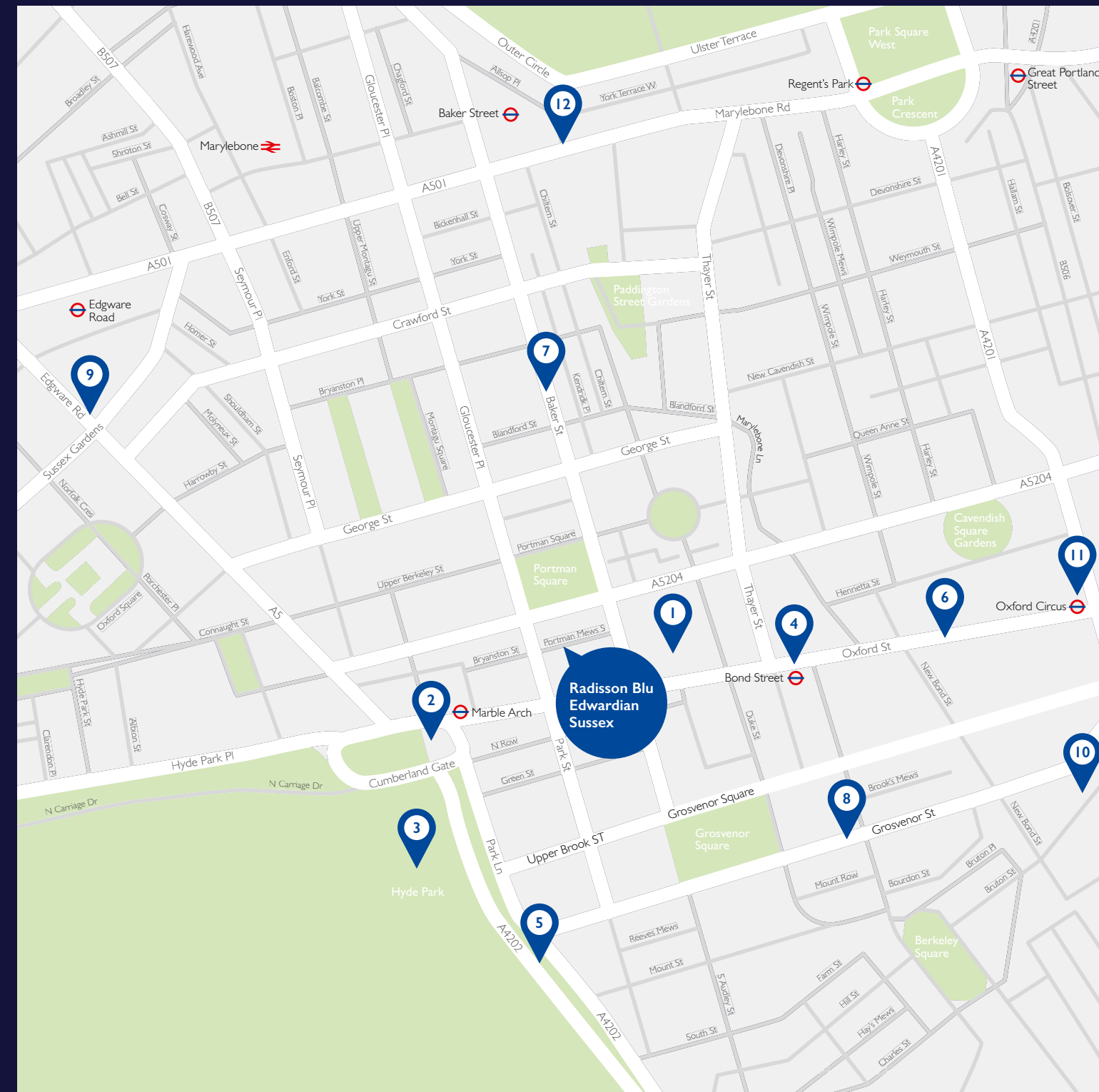



RADISSON BLU EDWARDIAN  
SUSSEX ★★★★★

19-25 Granville Place  
London  
W1H 6PA

**T** +44 (0)20 7845 8680

**E** [sussexcb@radisson.com](mailto:sussexcb@radisson.com)

**W** [radissonblu-edwardian.com/sussex](http://radissonblu-edwardian.com/sussex)

Owned and managed by Edwardian Hotels London