



MEETINGS AND EVENTS

# WELCOME

DISCOVER BLOOMSBURY'S LITERARY HERITAGE IN THE HEART OF LONDON'S WEST END.

With a grand lobby and wrought-iron staircase, the Bloomsbury Street hotel offers stylish luxury bedrooms and a buzzing restaurant, moments from the British Museum and Tottenham Court Road tube station.



Free high-speed Wi-Fi up to 150mbps on an unlimited number of devices



Edward, our virtual concierge is available to guests and meeting organisers 24/7



# FOOD FOR THOUGHT

DISCOVER WORLD-CLASS DINING IN AN ICONIC LOCATION

Our food and drink teams are here to ensure you stay energised, motivated and focused, with a range of delicious menus to choose from. We promise to go above and beyond to bring you the very best in innovative and responsible gastronomy.

Specifically designed to improve efficiency and your ability to concentrate, we have a fantastic range of simple, wholesome and tasty offerings. Menus can be tailored to your tastes, and our expert teams - dedicated and discreet, can set the scene to match the mood.

# EDWARD FOR MEETINGS

MEET EDWARD:  
YOUR DEDICATED  
CONFERENCE HOST

Edward is an innovative and unique chatbot, developed specifically to match the needs of the hospitality industry. He responds to guests' requests via SMS text messaging. Edward is available to all residential guests and organisers at the hotel.



# CAPACITIES



Theatre Classroom Boardroom U-shape Cabaret Reception Lunch/Dinner Dinner Dance

## GROUND FLOOR

	Theatre	Classroom	Boardroom	U-shape	Cabaret	Reception	Lunch/Dinner	Dinner Dance
Private Room 1	–	–	11	–	–	–	14	–
Folio Room	200	120	50	60	120	350	220	200
Folio 1 and 2	150	90	50	40	75	240	150	–
Folio 2 and 3	140	60	36	35	60	150	100	120
Folio 1	120	52	28	30	42	150	100	80
Folio 2	60	32	24	24	24	75	50	–
Folio 3	50	24	22	18	24	70	40	–

## LOWER GROUND FLOOR

Private Room 2	66	30	26	28	30	60	50	40
Private Room 3	40	15	18	18	16	40	30	–
Private Room 4	40	15	16	16	16	40	30	–
Private Room 5	40	18	16	18	21	40	30	–
Private Room 6	–	–	6	–	–	–	–	–

# FLOOR DIMENSIONS

	Area	Length m (ft)	Width m (ft)	Height m (ft)
<b>GROUND FLOOR</b>				
Private Room 1	34 m <sup>2</sup> (366 ft <sup>2</sup> )	6.3 m (20'67")	5.4 m (17'72")	2.9 m (9'51")
Folio Room	232 m <sup>2</sup> (2496 ft <sup>2</sup> )	23.2 m (76'12")	10 m (32'10")	2.9 m (9'51")
Folio 1 and 2	170 m <sup>2</sup> (1829 ft <sup>2</sup> )	17 m (55'77")	10 m (32'10")	2.9 m (9'51")
Folio 2 and 3	115 m <sup>2</sup> (1237 ft <sup>2</sup> )	11.5 m (37'73")	10 m (32'10")	2.9 m (9'51")
Folio 1	117 m <sup>2</sup> (1258 ft <sup>2</sup> )	11.7 m (38'39")	10 m (32'10")	2.9 m (9'51")
Folio 2	53 m <sup>2</sup> (570 ft <sup>2</sup> )	5.3 m (17'39")	10 m (32'10")	2.9 m (9'51")
Folio 3	62 m <sup>2</sup> (667 ft <sup>2</sup> )	6.2 m (20'34")	10 m (32'10")	2.9 m (9'51")
<b>LOWER GROUND FLOOR</b>				
Private Room 2	78.2 m <sup>2</sup> (841 ft <sup>2</sup> )	12.4 m (40'68")	5 m (16'40")	2.5 m (8'20")
Private Room 3	49.6 m <sup>2</sup> (534 ft <sup>2</sup> )	9 m (29'53")	5.6 m (18'37")	2.5 m (8'20")
Private Room 4	45.7 m <sup>2</sup> (492 ft <sup>2</sup> )	8.1 m (26'57")	5.7 m (18'70")	2.5 m (8'20")
Private Room 5	49.5 m <sup>2</sup> (533 ft <sup>2</sup> )	8.2 m (26'90")	6.1 m (20'01")	2.5 m (8'20")
Private Room 6	17.6 m <sup>2</sup> (189 ft <sup>2</sup> )	4.4 m (14'44")	4 m (13'12")	2.3 m (7'55")

# LOWER GROUND FLOOR

ALL MEETING ROOMS ARE FULLY AIR  
CONDITIONED AND BENEFIT FROM:

- Free, fast Wi-Fi up to 150Mbps
- Dedicated audio-visual support
- LCD projection screens
- Business centre with printing facilities
- Audio visual equipment, bespoke staging and additional lighting on request.

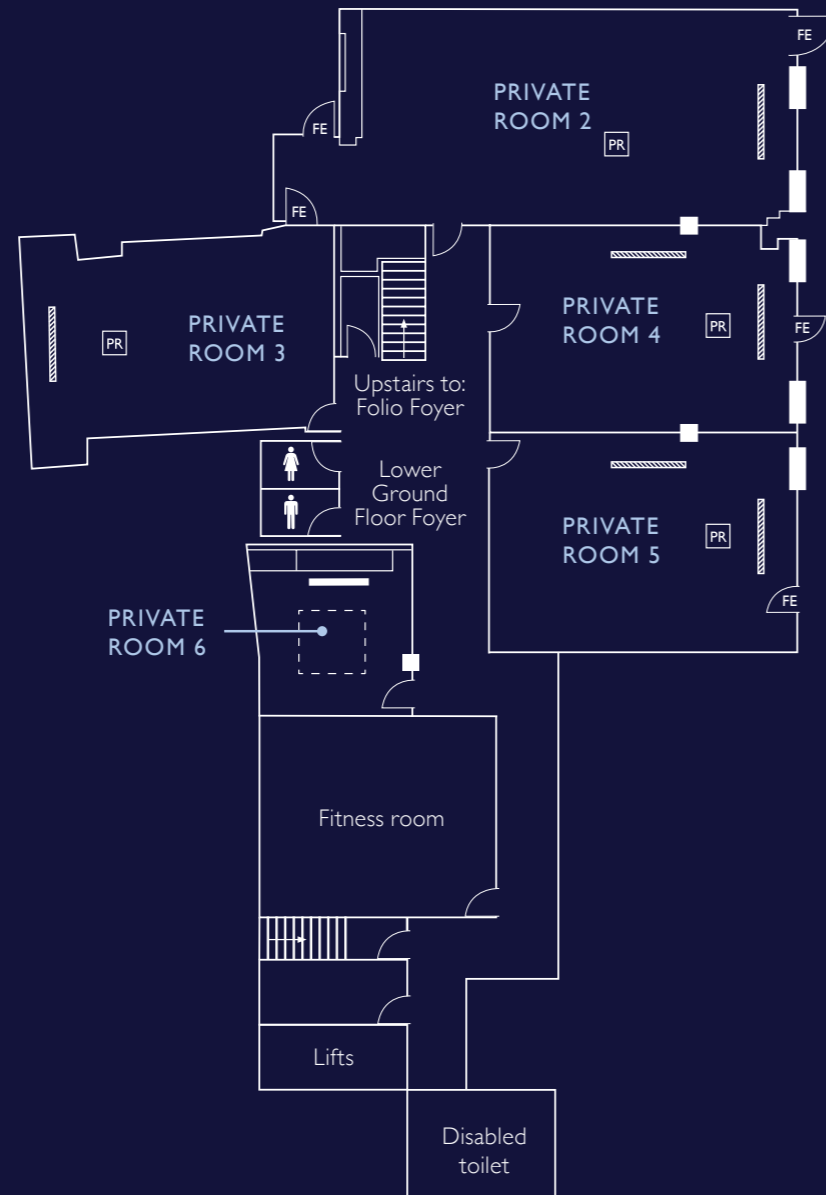

# GROUND FLOOR

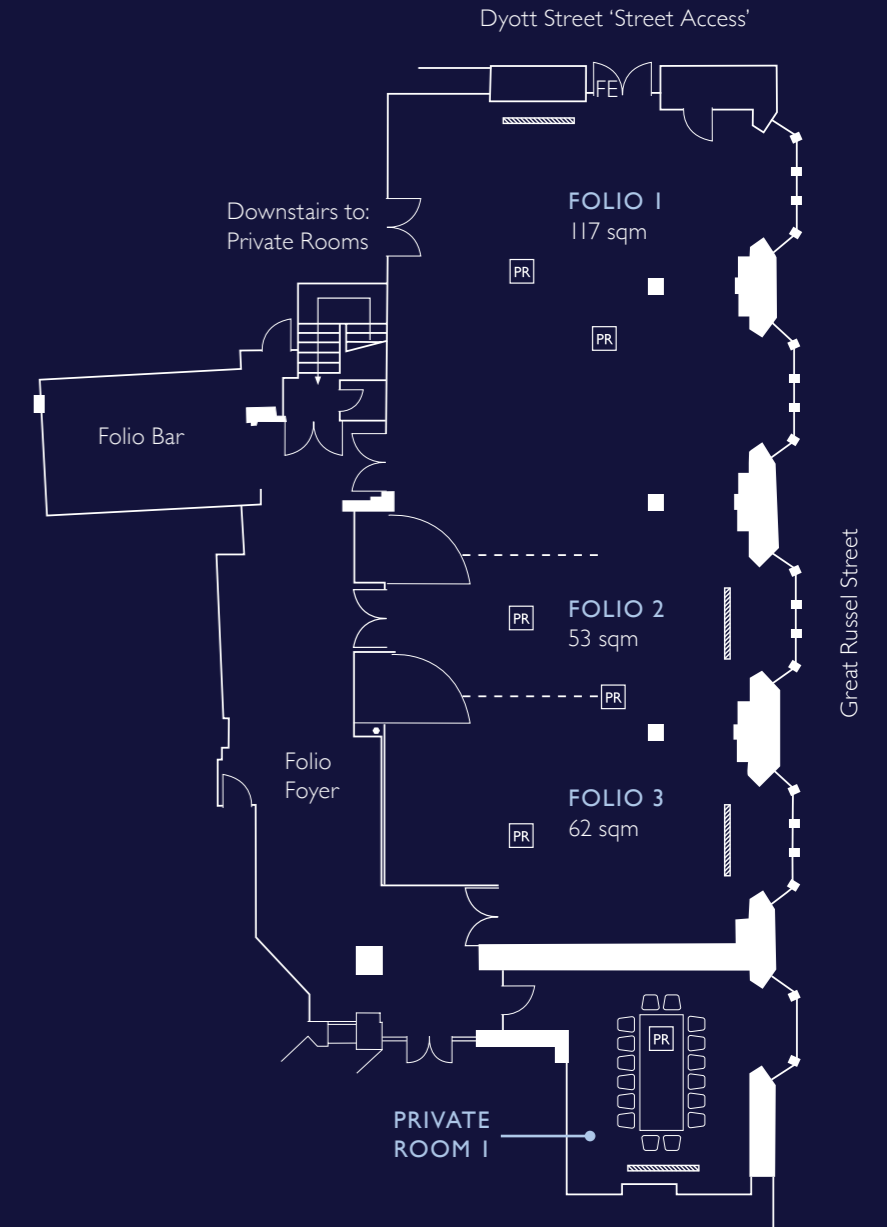

# LOCATION

## BLOOMSBURY STREET

A prime location, 50 metres from the British Museum, this hotel sits in the heart of the West End with Oxford Street, Covent Garden and Soho all on the doorstep. Close by, Tottenham Court Road and Holborn tube stations provide direct access to the City,

### BLOOMSBURY ST

★★★★ (deluxe)

9-13 Bloomsbury Street  
London  
WC1B 3QD

T +44 (0)20 7666 2322

E bshcb@radisson.com

### TRAVEL

#### Car Park

Great Russell Street

#### Underground

Tottenham Court Road  
(Central and Northern Lines)

#### Crossrail

Tottenham Court Road  
(Elizabeth Line)

#### Trains

Euston (1 mile)

King's Cross St. Pancras  
Eurostar (1.7 miles)

#### Airport

City Airport (9 miles)  
Heathrow (18 miles)  
Gatwick (28 miles)  
Luton (35 miles)  
Stansted (37 miles)

### POINTS OF INTEREST

- 1 The Cartoon Museum (1 min walk)
- 2 British Museum (1 min walk)
- 3 The Shaftesbury Theatre (1 min walk)
- 4 Dominion Theatre (4 mins walk)
- 5 Literary Tour of Bloomsbury (8 mins walk)
- 6 London Transport Museum (10 mins walk)
- 7 Covent Garden (12 mins walk)
- 8 Somerset House (15 mins walk)
- 9 Oxford Street (17 mins walk)
- 10 Bond Street (20 mins walk)

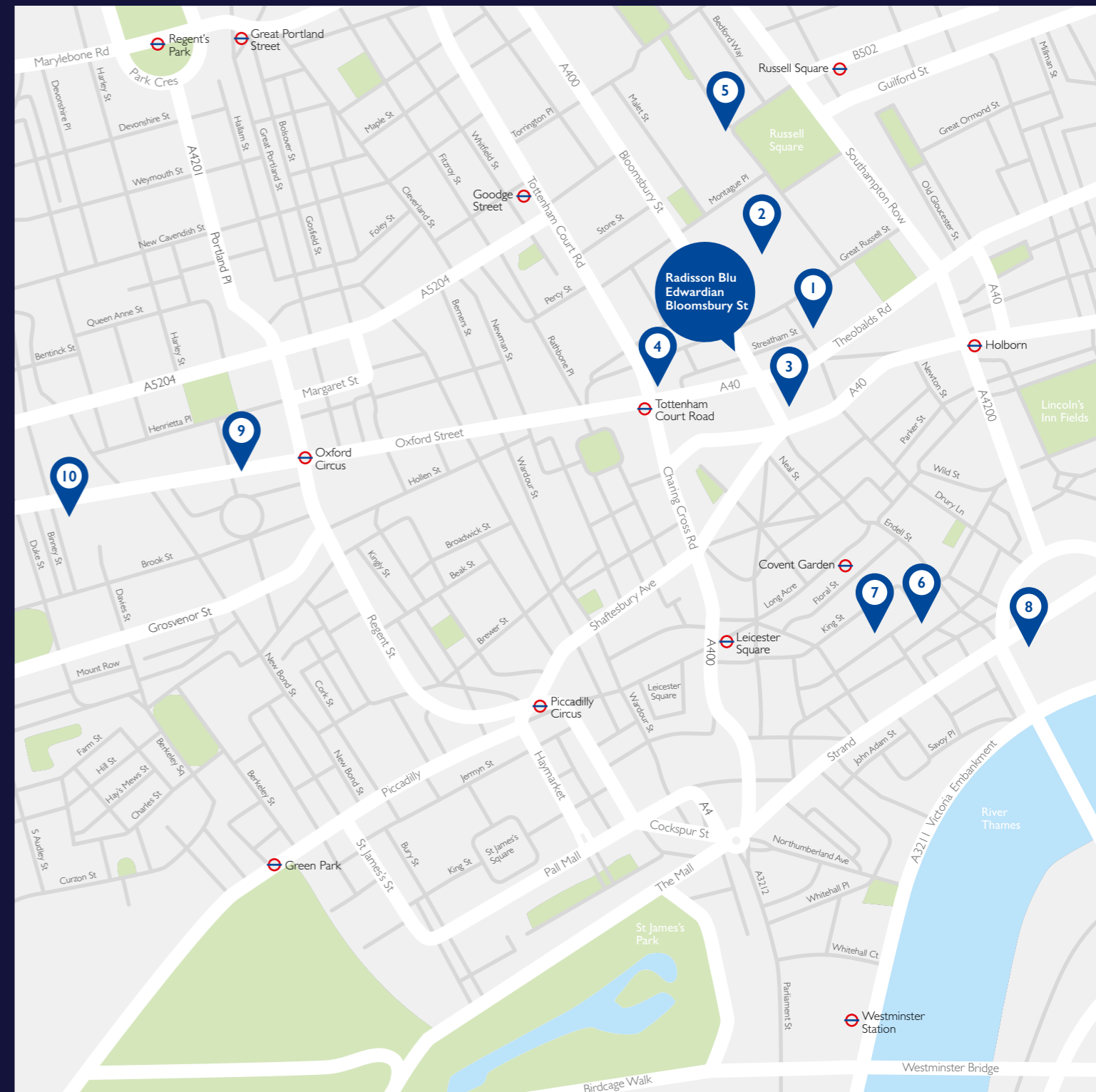



RADISSON BLU EDWARDIAN  
BLOOMSBURY ST ★★★★★ (deluxe)

9-13 Bloomsbury Street  
London  
WC1B 3QD

**T** +44 (0)20 7666 2322

**E** [bshcb@radisson.com](mailto:bshcb@radisson.com)

**W** [radissonblu-edwardian.com/bloomsburystreet](http://radissonblu-edwardian.com/bloomsburystreet)

Owned and managed by Edwardian Hotels London